

LINEAR OPTICS 3R FOR SMD COMFORT-B



LINEAR OPTICS 3R FOR SMD COMFORT-B

Due to the light distributions, the highly efficient optics made of high class optical materials offer diverse possibilities for use in the application fields of retail, corridor and shelf lighting as well as for industrial and hall lighting (IP40).

The individual lenses are suitable for 3030 and 2835 midpower LEDs from leading LED manufacturers. Typical LED types for use with these optics are Cree JE2835, Seoul STW8C2PB, STW8C12C, STW9C2PB (including Sunlike LEDs), Samsung LM301B, Nichia 757 (also as Tuneable White).

The frosted optics have a very low colour deviation across the light distribution angle (CLC) and low UGR value. The length of the optics of 500 mm is perfect to realise luminaire louvre dimensions of 1,500 mm.

The optics are available with 60 and with 90 single lenses for industrial applications where high lumen output is required.

Linear Optics 3R for SMD Comfort-B

- **EXCELLENT GLARE-FREE OPTICS DESIGN**
- **OPTICAL EFFICIENCY: UP TO 95%**
- **VARIANTS WITH UGR AND CLC OPTIMISED LIGHT DISTRIBUTION AVAILABLE**
- **UV-RESISTANT**
- **HO VERSION WITH 90 LENSES**

Linear optics 3R for SMD Comfort-B HO 90 single lenses 500 mm IP40

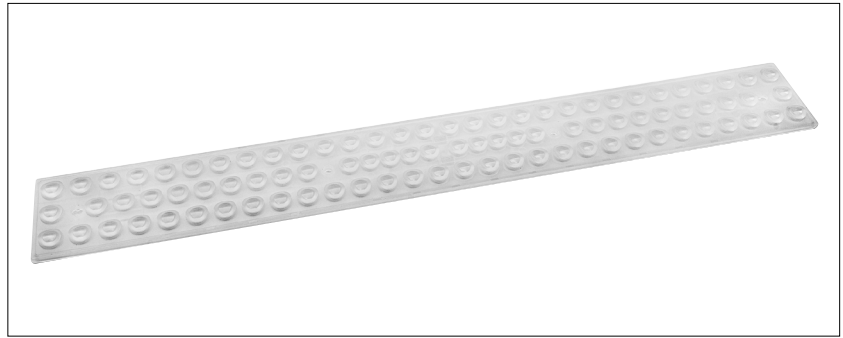

Technical notes

- Material: PC
- Max. allowed temperature: 100 °C
- Dimensions (LxWxH): 500x62x4.2 mm
- Fixation with flat or cylinder head screws (M4) or with fixing expanding rivets
- Max. torque: 1.2 Nm (M4)



Lighting properties

- CLC (constant light colour): very low colour temperature deviations over beam angle
- UGR: optimized glare reduction
- E95 - Efficiency > 95%

Light distribution	Type	Ref. No.	Lighting properties	Material	Efficiency* %	Degree of protection	Weight g	Packaging unit pcs.
High Rack	96322	573686	UGR	Clear	94	IP40	107	140
Diffuse 90°	96322	573687	CLC	Diffuse	86	IP40	107	140
Medium 60°	96323	573688	UGR, E95	Clear	95	IP40	95	140

* Measured on a white luminaire sheet

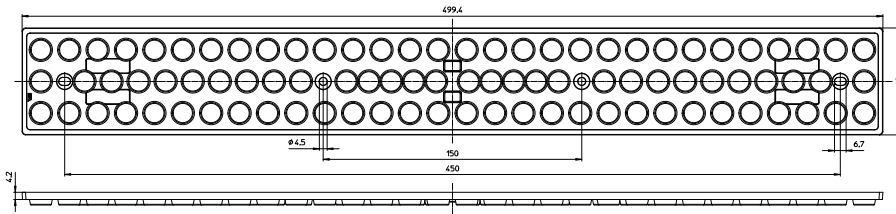

The values contained in this data sheet can change due to technical innovations. Any such changes will be made without separate notification.

Linear optics 3R for SMD Comfort-B HO 90 single lenses 500 mm IP40

Typ. light distributions with VS LED modules (with Cree JE2835)

At www.vossloh-schwabe.com you will find further light distribution curves with other LED types as well as all data in .ldt and .ies format for download.

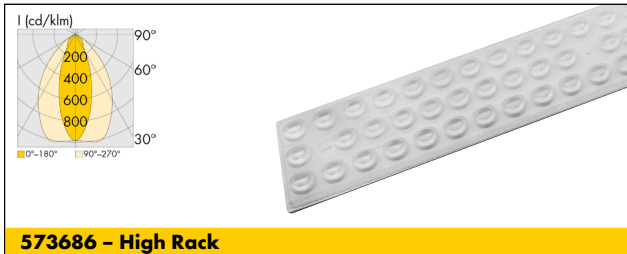

Suitable VS LED modules

Linear optics 3R for SMD Comfort-B HO 90 single lenses 500 mm IP40 are suitable for 3-row modules LED Line SMD W5.5 3R Comfort-B HO G1.

VS LED modules	Module type
LED Line SMD W5.5 3R Comfort-B HO G1	MLC SC W5.5/500 B/90/yzz HO G1

The values contained in this data sheet can change due to technical innovations. Any such changes will be made without separate notification.

Linear optics 3R for SMD Comfort-B

60 single lenses

500 mm IP40

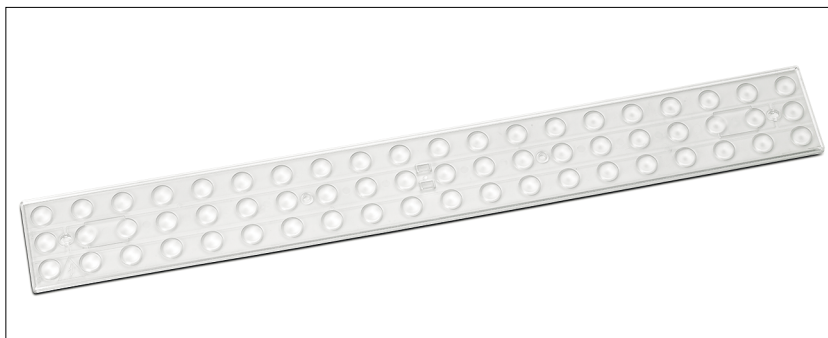

Technical notes

- Material: PMMA, clear
- Max. allowed temperature: 80 °C
- Dimensions (LxWxH): 500x62x4.2 mm
- Fixation with flat or cylinder head screws (M4) or with fixing expanding rivets
- Max. torque: 1.2 Nm (M4)



Lighting properties

- CLC (constant light colour): very low colour temperature deviations over beam angle
- UGR: optimized glare reduction
- E95 - Efficiency > 95%

Light distribution	Type	Ref. No.	Lighting properties	Material	Efficiency* %	Degree of protection	Weight g	Packaging unit pcs.
Extra Wide 110°	96304	571094	UGR, CLC, E95	clear	95	IP40	74.5	160
Wide 90°	96300	569527	UGR, E95	clear	95	IP40	76.3	160
Medium 60°	96303	571093	UGR, E95	clear	95	IP40	87.1	140
High Rack	96302	571092	UGR, E95	clear	95	IP40	90.5	140
Hight Rack CLC	96302	572154	UGR, CLC	clear	91	IP40	90.5	140
Retail SYM	96301	569528	UGR, CLC, E95	clear	95	IP40	87.2	140
Diffuse 110°	96304	570378	CLC	diffuse	94	IP40	72.4	160

* Measured on a white luminaire sheet

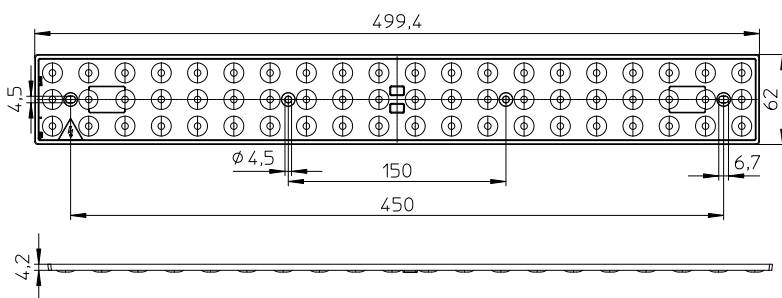

The values contained in this data sheet can change due to technical innovations. Any such changes will be made without separate notification.

Linear optics 3R for SMD Comfort-B 60 single lenses 500 mm IP40

Typ. light distributions with VS LED modules (with Cree JE2835)

At www.vossloh-schwabe.com you will find further light distribution curves with other LED types as well as all data in .ldt and .ies format for download.

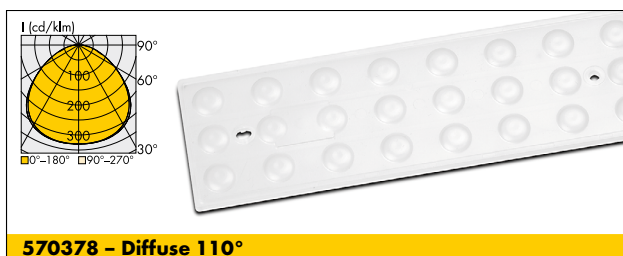

Suitable VS LED modules

Linear optics 3R for SMD Comfort-B 60 single lenses 500 mm IP40 are suitable for 3-row modules LED Line SMD Comfort-B 3R.

VS LED modules	Module type
LED Line SMD Comfort-B 3R	WU-M-619-BC

The values contained in this data sheet can change due to technical innovations. Any such changes will be made without separate notification.

Fixing expanding rivets for optics together with the LED PCB

For screwless fastening of optics type 963 together with the LED PCB to the luminaire sheet

Vibration resistant version

Material: PA, natural (UL-94 V-2)

For PCB fixing hole diameter: $\varnothing 4.1$ mm

The clamping range (MT) is a sum of PCB thickness (PCB) + optics thickness (O) + luminaire sheet thickness (Metal sheet).

Weight: 0.2 g

Packaging unit: 1000 pcs.

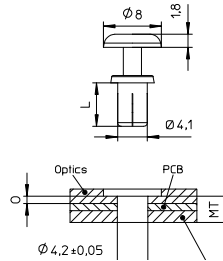

Type	Ref. No.	For clamping range (MT) mm	Length (L) mm
98004	569408	4.5–5.5	7
98001	562557	5.5–6.5	8
98002	562558	6.5–7.5	9
98003	562559	7.5–8.5	10

Material thickness of VS optics

Optics type	Material thickness (O) (mm)
963	2.4

The values contained in this data sheet can change due to technical innovations. Any such changes will be made without separate notification.