



BLUETOOTH® WIRELESS
DALI CONTROLLER FOR
IN-/OUTDOOR APPLICATIONS



BLUETOOTH® WIRELESS DALI CONTROLLER FOR IN-/OUTDOOR APPLICATIONS

Blu2Light – The intelligent wireless lighting control solution

Blu2Light is the first completely open Bluetooth® wireless technology system with mesh functionality for the professional lighting market, which, in addition to a variety of functions for lighting control, offers the luminaire manufacturer added IoT benefits with maximum system security.

Blu2Light Connect T-ME /T-ME-S

The power is supplied via DALI.

Blu2Light Connect T-ME /T-ME-S

- **ENABLES THE INTEGRATION OF THE BLU2LIGHT NETWORK IN STREET, BOLLARD AND INDUSTRY LIGHTING**
- **INTEGRATED BLUETOOTH® MESH RADIO MODULE**
- **USER FRIENDLY**
- **OPERATING LIFETIME: 50,000 HRS.**
- **PRODUCT GUARANTEE: 5 YEARS**
- **IP67 PROTECTED CASING**



Blu2Light Connect T-ME /T-ME-S

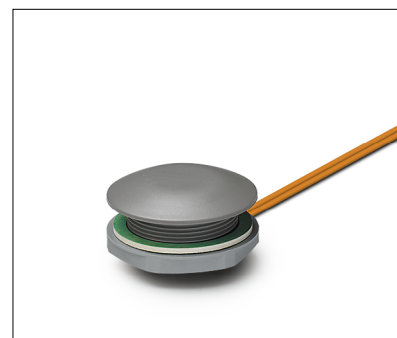
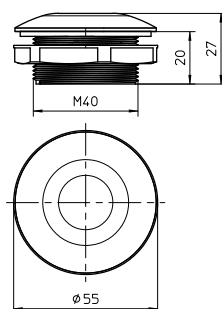

Type	Connect T-ME /T-ME-S
Ref. No.	187295 /187458
Communication	Blu2Light Mesh Network
Frequency range	2402–2480 MHz
HF output power	< 10 mW EIRP
Power consumption standby/operation	< 0.24 W
Power supply	DALI power supply
IP protection	IP67
Protection class	II
Dimensions (Ø x H)	55x27 mm
Casing	Makrolon, grey RAL 7023
Weight	50 g

Product guarantee

5 years

The conditions for the Product Guarantee of the Vossloh-Schwabe Group shall apply as published on our homepage (www.vossloh-schwabe.com).

We will be happy to send you these conditions upon request.



Configuration	Connect T-ME 187295	Connect T-ME-S 187458
Mains supply	–	–
Power supply via DALI	Yes	Yes
DALI output*	1 active DALI driver	1 active DALI driver
DALI addresses	64	64
Functional groups	1	16
Scenes	64	64
Sequences	–	64
Timer	32	32
RGBW/ DTS	XY/TC	XY/TC
Full Blu2Light compatibility	Yes	Yes

* or up to 64 passive DALI drivers with one Extender 64

Product labels

Vossloh-Schwabe Deutschland GmbH
Stuttgarter Straße 61/1, 73614 Schorndorf

Blu2Light Connect T-ME

Ref.-No. 187295
Developed in Germany
Made in Serbia (Europe)

Vossloh-Schwabe Deutschland GmbH
Stuttgarter Straße 61/1, 73614 Schorndorf

Blu2Light Connect T-ME-S

Ref.-No. 187458
Developed in Germany
Made in Serbia (Europe)

The values in this data sheet may change due to technical innovations and are subject to change without notice.

Blu2Light Connect T-ME /T-ME-S

General Safety and Mounting Instructions

Only qualified persons are allowed to install Blu2Light products.

Prior to installing and commissioning the system, read these instructions carefully. Only this will guarantee correct and safe handling. Please keep these instructions as you may need them later.

The devices must always be disconnected before any work is carried out on them.

The applicable safety and accident prevention regulations must be observed.

Opening by unqualified personnel of the products is prohibited: Risk of death from electric shock!

The devices must only be repaired by the manufacturer.

Only DALI power supply may be connected.

Overvoltage protection of the DALI interface: Connecting higher voltages than DALI voltage will destroy the products. Operation with 24 V / 110 V / 230 V is generally not permitted!

The Blu2Light In-/Outdoor control units are designed to control street and bollard lights.

Mounting

Feed the lines first through the O-ring and then through the pre-drilled hole (Ø 40 mm) from the outside. Then put on the enclosed nut from the inside and screw it tight. Then connect the pre-assembled cables.

A DALI power supply must be present on the input side.

Setup and operation

The Blu2Light devices are configured with the LiNA Connect app and can be operated via the LiNA Touch app.

For the exact procedure for the configuration of the devices please refer to the instructions in the LiNA Connect app or in the corresponding documentation.

A tablet is required for setup, both tablets and smartphones can be used for operation. Both are not included in the scope of delivery.

For information on the iOS and Android operating systems that can currently be used, refer to the LiNA Connect/ LiNA Touch manual:



Bluetooth® wireless technology

The Bluetooth® word mark and logos are registered trademarks owned by the Bluetooth SIG, Inc. and any use of such marks by Vossloh-Schwabe is under license. Other trademarks and trade names are those of their respective owners.

Important note:

Please refer to the installation instructions included with the product and the applicable Blu2Light system data sheet before installation. Make sure that the Bluetooth radio signal can propagate freely according to the specifications.

All Blu2Light devices that are supplied via DALI may only be connected to one DALI power supply! Therefore, it is not permissible to connect several Blu2Light devices to one power supply. In this case, malfunctions will occur. CAUTION: If this Blu2Light product is connected to several DALI drivers with an active DALI interface (e.g. D4i), the product may be permanently damaged immediately after the operating voltage is applied if the sum of the individual supplies exceeds the maximum DALI current. Switching on the supply voltage without first checking the maximum current must therefore be ruled out. If necessary, the power supplies of individual DALI devices must be deactivated individually before commissioning the system; the steps required for this can be found in the manual of the respective manufacturer of the operating device.



We, Vossloh-Schwabe Deutschland GmbH, herewith confirm that these devices comply with the basic requirements of the directive 2014/53 / EU and other relevant directives. The entire text of the declaration of conformity can be obtained from the following address:
www.vossloh-schwabe.com

The values in this data sheet may change due to technical innovations and are subject to change without notice.