

CC COMPACT SELECTABLE



EASYLINE DIP SWITCH R-R3

187050, 187051, 187052

Typical Applications

Built-in in compact luminaires for

- Shop lighting
- Office lighting

EasyLine DIP switch R-R3

- **SELECTABLE OUTPUT CURRENT VIA DIP SWITCH**
- **VERY LOW RIPPLE CURRENT: < 3%**
- **SELV**
- **ESPECIALLY SPACE-SAVING CASING DESIGN**
- **LONG SERVICE LIFE: UP TO 50,000 HRS.**
- **PRODUCT GUARANTEE: 5 YEARS**



EasyLine DIP switch R-R3

Product features

- Round casing shape

Functions

- Selectable current output by secondary side DIP switch.
- The required current output can be chosen by dip switches.

Electrical features

- Mains voltage: 220–240 V ±10%
- Mains frequency: 50–60 Hz
- Push-in terminals: 0.2–1.5 mm²
- Power factor at full load: > 0.95
- Open circuit voltage (U_{max.}): 60 V
- Secondary side switching of LED modules is not allowed.

Safety features

- Protection against transient main peaks up to 1 kV (between L and N)
- Electronic short-circuit protection
- Overload protection
- Protection against "no load" operation
- Degree of protection: IP20
- Protection class II
- SELV
- SVM: < 0.4
- PstLM: < 1

Packaging units

Ref. No.	Packaging unit		
	Pieces per box	Boxes per pallet	Weight g
187050	120	75	52
187051	30	130	59
187052	30	130	90



Dimensions

- Casing: K84
- Ref. No.: 187050
- Diameter: 45 mm
- Height: 20.4 mm

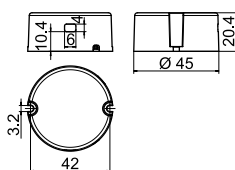

- Casing: K85
- Ref. No.: 187051, 187052
- Diameter: 55 mm
- Height: 25 mm

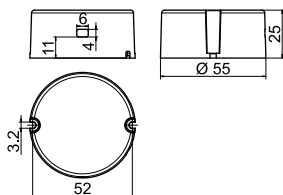

Applied standards

- EN 61347-1
- EN 61347-2-13
- EN 61547
- EN 61000-3-2
- EN 62384
- EN 55015



Product guarantee

- 5 years for operation at recommended operation temperature (see table for expected service life time on the next page)
- The conditions for the Product Guarantee of the Vossloh-Schwabe Group shall apply as published on our homepage (www.vossloh-schwabe.com). We will be happy to send you these conditions upon request.

The values contained in this data sheet can change due to technical innovations. Any such changes will be made without separate notification.

LED Drivers – EasyLine DIP switch R-R3

Electrical characteristics

Max. output W	Type	Ref. No.	Voltage 50–60 Hz V	Mains current mA	Inrush current A / μ s	Current output DC mA (\pm 5%)	Voltage output DC (V)	THD at full load % (230 V)	Efficiency at full load % (230 V)	Ripple 100 Hz %
15	ECXe 350.433	187050	220–240	82–66	10 / 139	250–350	27–40	10	> 87	< 2
20	ECXe 500.434	187051	220–240	118–92	15 / 164	400–500	30–40	5	> 90	< 3
28	ECXe 700.435	187052	220–240	161–123	15 / 158	600–700	30–40	6	> 90	< 2

Maximum ratings

Exceeding the maximum ratings can lead to reduction of service life or destruction of the drivers.

Ref. No.	Ambient temperature range		Operation humidity range		Storage temperature range		Storage humidity range		Max. operation temperature at t_c point °C	Degree of protection
	°C min.	°C max.	% min.	% max.	°C min.	°C max.	% min.	% max.		
187050	-20	+50	5	95	-40	+80	5	95	+80	IP20
187051									+75	
187052									+85	

Expected service life time

at operation temperatures at t_c point

Operation current	Ref. No.					
	187050		187051		187052	
All	70 °C*	80 °C	65 °C*	75 °C	75 °C*	85 °C
hrs.	50,000	35,000	50,000	35,000	50,000	35,000

* recommended operation temperature

Product labels

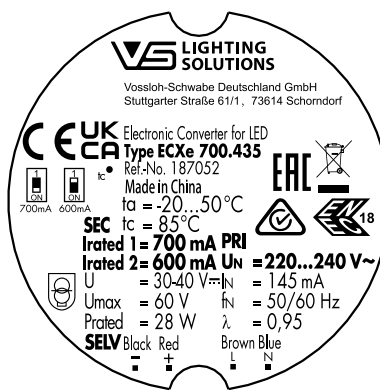
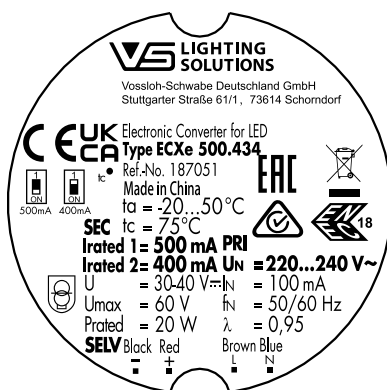
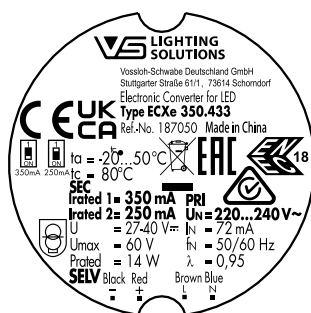

The values contained in this data sheet can change due to technical innovations. Any such changes will be made without separate notification.

Typ. performance graphs for 187050 / Type ECXe 350.433

Working area

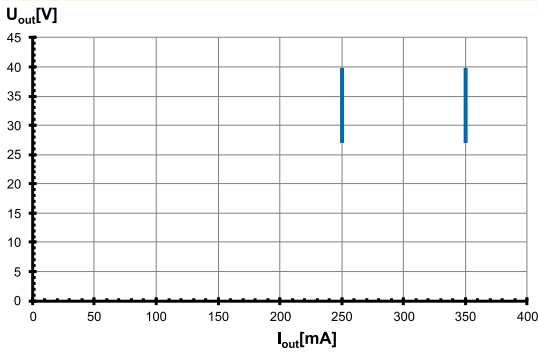

Efficiency

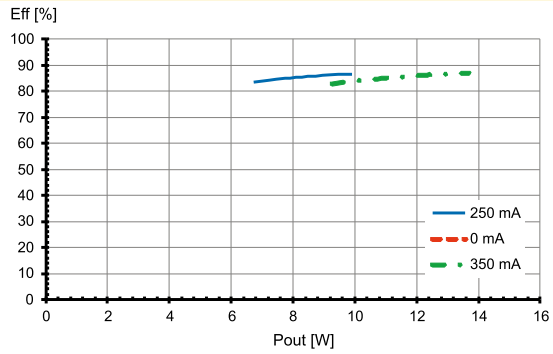

Power factor

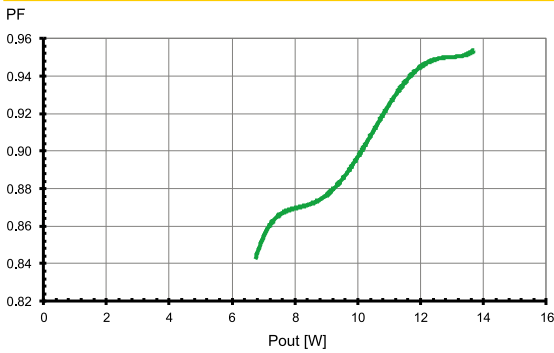

Total harmonic factor (THD)

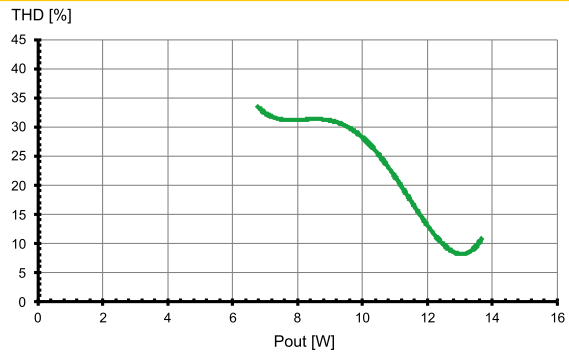

Typ. performance graphs for 187051 / Type ECXe 500.434

Working area

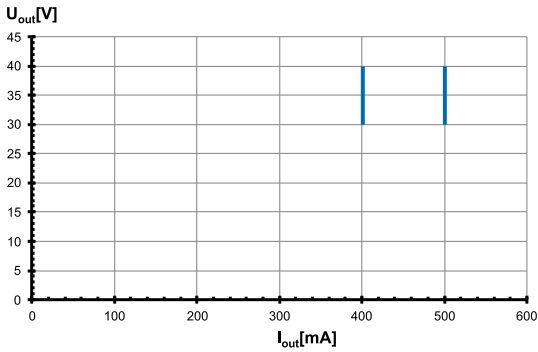

Efficiency

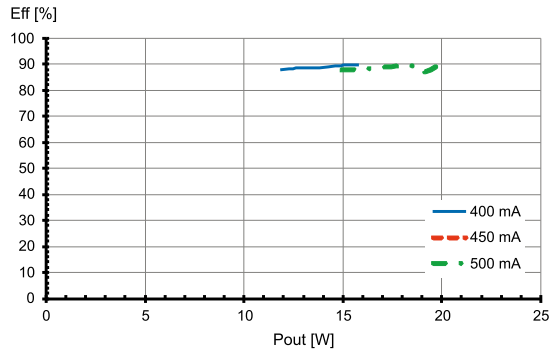

Power factor

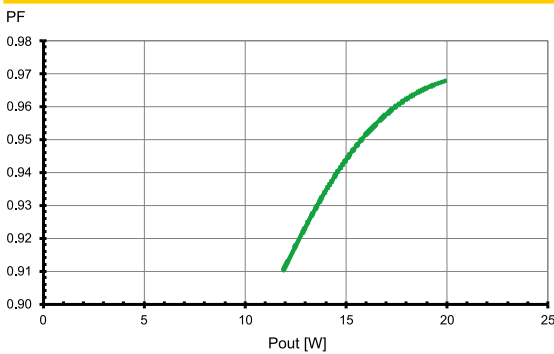

Total harmonic factor (THD)

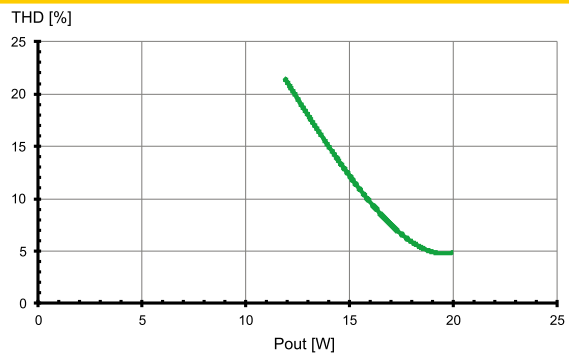

The values contained in this data sheet can change due to technical innovations. Any such changes will be made without separate notification.

Typ. performance graphs for 187052 / Type ECXe 700.435

Working area

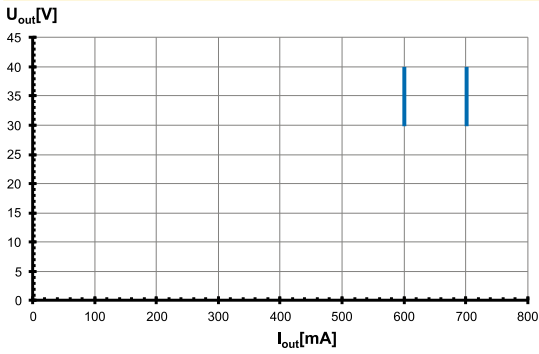

Efficiency

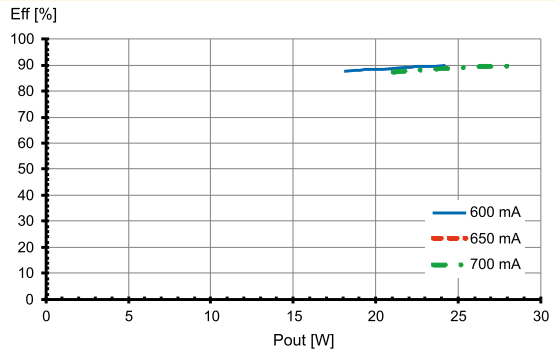

Power factor

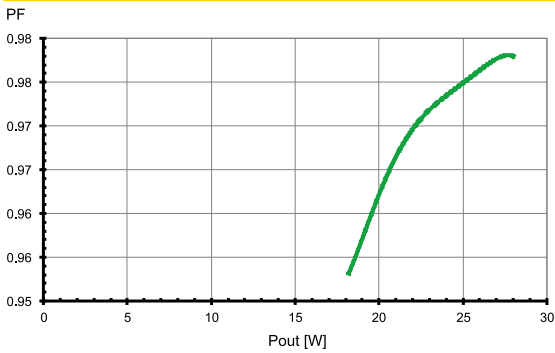

Total harmonic factor (THD)

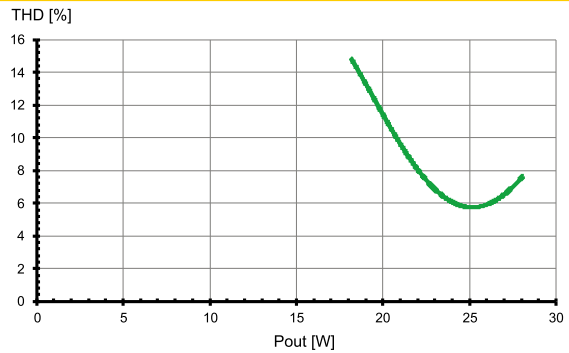

The values contained in this data sheet can change due to technical innovations. Any such changes will be made without separate notification.

Safety functions

- Transient mains peaks protection:
Values are in compliance with EN 61547
(interference immunity).
Surges between L–N: up to 1 kV
- Short-circuit protection: The control gear is protected against
permanent short-circuit with automatic restart
function.
- Overload protection: The control gear only works in range of rated
output power and voltage problemfree
(< 60 V DC).
Please check before switch-on mains power
supply that the selected LED load is suitable
(see Electrical Characteristics on data sheet).
- No load operation: The control gear is protected against no load
operation (open load).
- If any of the above mentioned safety functions will be triggered, dis-
connect the control gear from the power supply then find and eliminate
the cause of the problem.

Assembly and Safety Information

Installation must be carried out under observation of the relevant regulations and standards. Installation must be carried out in a voltage-free state (i.e. disconnection from the mains). The following advices must be observed; non-observance can result in the destruction of the LED drivers, fire and/or other hazards.

Mandatory regulations

- DIN VDE 0100
- EN 60598-1

Mechanical mounting

- Mounting position: Independent application: Drivers are allowed to use for independent applications
- Mounting location: LED drivers are designed for integration into luminaires or comparable devices.
Independent LED drivers do not need to be integrated into a casing.
Installation in outdoor luminaires: degree of protection for luminaire with water protection rate 4 (e.g. IP54 required).
- Degree of protection: IP20
- Clearance: Min. 0.10 m from walls, ceilings and insulation
- Surface: Solid and plane surface for optimum heat dissipation required.
- Heat transfer: If the driver is destined for installation in a luminaire, sufficient heat transfer must be ensured between the driver and the luminaire casing.
LED drivers should be mounted with the greatest possible clearance to heat sources.
During operation, the temperature measure at the driver's t_c point must not exceed the specified maximum value.
- Fastening: Using M4 screws in the designated holes
- Tightening torque: 0.2 Nm

Electrical installation

- Connection terminals: Push-in terminals for rigid or flexible conductors with a section of 0.2–1.5 mm²
- Stripped length: 8.5–10 mm
- Wiring: The mains conductor within the luminaire must be kept short (to reduce the induction of interference).
Mains and lamp conductors must be kept separate and if possible should not be laid in parallel to one another.
Max. secondary side lead length: 0.8 m
- Polarity: Please ensure the correct polarity of the leads prior to commissioning. Reversed polarity can destroy the modules.
- Through-wiring: Is not allowed.

- Secondary load: The sum of forward voltages of LED loads is within the tolerances which are mentioned in the Electrical Characteristics on the data sheet.
- Parallel wiring: Parallel connection of LED loads is not allowed.
- Wiring diagram:

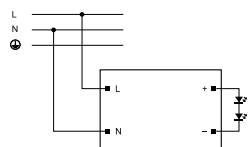

Selection of automatic cut-outs for VS LED drivers

- Dimensioning automatic cut-outs
High transient currents occur when an LED driver is switched on because the capacitors have to load. Ignition of LED modules occurs almost simultaneously. This also causes a simultaneous high demand for power. These high currents when the system is switched on put a strain on the automatic conductor cut-outs, which must be selected and dimensioned to suit.
- Release reaction
The release reaction of the automatic conductor cut-outs comply with VDE 0641, part 11, for B, C characteristics. The values shown in the following tables are for guidance purposes only and are subject to system-dependent change.
- No. of LED drivers
The maximum number of VS LED drivers applies to cases where the devices are switched on simultaneously. Specifications apply to single-pole fuses. The number of permissible drivers must be reduced by 20% for multi-pole fuses. The considered circuit impedance equals 400 m (approx. 20 m [2.5 mm²] of conductor from the power supply to the distributor and a further 15 m to the luminaire).

Type	Ref. No.	Automatic cut-out type and possible no. of VS drivers pcs.					
Automatic cut-out type		B 10 A	B 13 A	B 16 A	C 10 A	C 13 A	C 16 A
ECXe 350.433	187050	60	78	96	100	130	160
ECXe 500.434	187051	33	43	53	56	72	89
ECXe 700.435	187052	35	45	56	58	75	93

The values contained in this data sheet can change due to technical innovations. Any such changes will be made without separate notification.